

• TRUSTED QUALITY SINCE 1921 •

RUST-OLEUM®

Cabinet Transformations™

Instructional Pamphlet

262925 0811

• TRUSTED QUALITY SINCE 1921 •

RUST-OLEUM®

Cabinet Transformations™

How to Apply Cabinet Transformations™

Rust-Oleum® Cabinet Transformations™ is a revolutionary do-it-yourself cabinet coating system that enables you to easily and affordably transform your cabinets from an outdated look to a beautiful and durable new finish.

IMPORTANT: These instructions include several important information boxes with critical, how-to information necessary to ensure the best product application process and highest quality results. Read in its entirety before beginning the project.

BEFORE YOU BEGIN

View Instructional DVD. The DVD provided with your kit offers a helpful, step-by-step overview on how to apply Cabinet Transformations™.

GATHER YOUR TOOLS AND SUPPLIES

Collect supplies needed for your project using the Project Supplies Checklist below.

PROJECT SUPPLIES CHECKLIST

INCLUDED IN KIT

Cabinet Transformations™ Coating System

- Instructional DVD and Pamphlet
- Deglosser
- Bond Coat*
- Decorative Glaze
- Protective Top Coat
- Decorative Glazing Cloths
- Scrub Pads
- Stir Sticks

NOT INCLUDED IN KIT

Other Items Needed:

- (3) 5cm (2") Synthetic Paint Brushes - Premium Quality Angled or Straight
- (1) 5cm (2") Foam Paint Brush (for optional glaze)
- Smooth Painter's Tape (5cm (2") size)
- Drop Cloths
- Disposable Gloves
- Lint-Free Rags
- Disposable Paint Containers

Suggested Items Needed:

- Screwdriver or Cordless Screwdriver
- Plastic Wood Filler and Putty Knife (if filling hardware holes)
- Plastic or Cork Bumpers
- Plastic Cups or Baggies (for hardware)
- Sketch Paper and Marker

IMPORTANT: Apply when air (ambient) temperature is 10 – 32° C (50 – 90° F) and relative humidity is below 60%.

* Bond Coat must be tinted prior to application.

HOW TO MEASURE COVERAGE

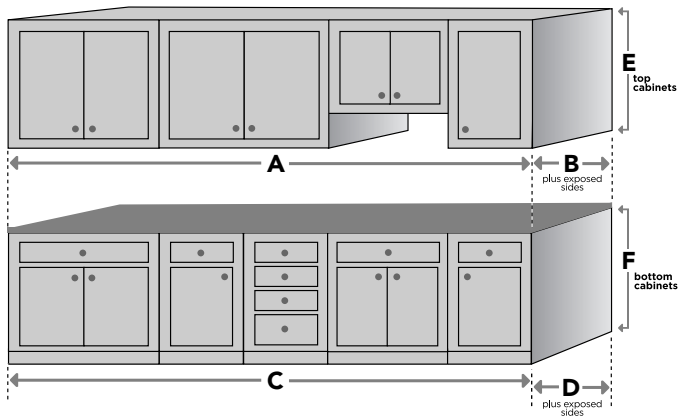

Square Meter – Calculate your exact coverage needs

STEP 1: Measure the length of your top cabinets ($A + B$) in centimeters and multiply by the height (E). Standard wall cabinet heights are: 30.5 – 45.7cm and 76 – 106cm (12" – 18" and 30" – 42").

STEP 2: Measure the length of your bottom cabinets in centimeters ($C + D$) and multiply by the height (F). Standard base cabinet height is: 87.6cm (34.5").

STEP 3: Add these two totals together and divide by 10,000 to determine the total square meters (144 for sq. ft.) you will need to cover.

Visit RustoleumTransformations.com to use our online calculator.

IMPORTANT: Properly measure your cabinetry prior to starting the project. If these measurements exceed the coverage on your kit package, you will need to purchase an additional kit.

PREPARE FOR THE PROJECT

For best results take cabinet doors off hinges and drawers out of frames. Remove all cabinet hardware, including hinges, drawer pulls, and knobs. Laying cabinet doors and drawers on a flat, horizontal surface while coating will ensure the easiest application and best outcome. Create an assembly line of cabinet doors and drawers to speed up the process.



To continue your cabinet transformation, now is the time to consider updating or replacing your cabinet hardware.

- A. Establish a location in close proximity to your kitchen to stage and coat your cabinet doors and drawers. Garages or basements are ideal locations for this step. Be certain that this area is dirt and dust free, out of the sun, and away from the wind. It is recommended that your work area be well ventilated, but do not use a fan.

Create a work table using a fold-out table or craft paper covered board with sawhorses. Tarp off the floor, table, and surrounding area.

- B. Sketch a layout of your kitchen, numbering all doors and drawers. Once complete, label all doors and drawers according to the sketch shown to the right with a piece of smooth painter's tape.

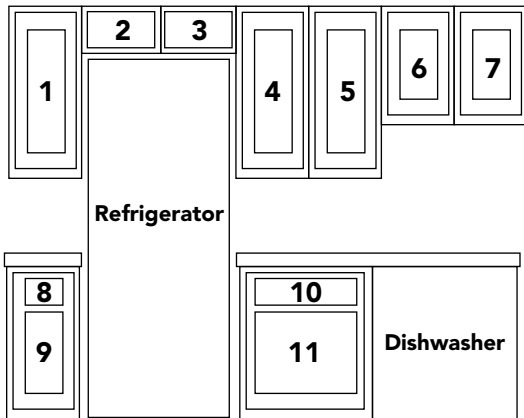

- C. Take off each door and drawer along with its correlating screws, hinges, knobs, and pulls. For organizational purposes, use a cup or baggie to place each door and drawer hardware in to. For example, if you have 16 door and drawer fronts, you should have 16 cups with each door's and drawer's hardware inside them. Use the same numbering system on the cups as you did with the door fronts.



Using a cordless screwdriver to remove cabinet hardware will speed up the process. If changing cabinet hardware, check to see if new or different holes are needed. Fill all holes not needed.

- D. Fill all nicks, gouges, cracks, or holes with plastic wood. Use a putty knife to apply the wood filler. Allow to dry and sand smooth to the surrounding areas.
- E. Remove all door bumpers using a putty knife and discard.

STEP #1 – CLEAN AND DEGLOSS

The Cabinet Transformations™ Deglosser prepares the surface and allows proper adhesion of the Bond Coat. The Deglosser eliminates the need to sand or prime the cabinets. Proper adhesion is critical to ensure optimum results.

IMPORTANT: To ensure optimum results and maximum adhesion of the Bond Coat, make sure you are THOROUGH in your deglossing of the cabinet doors, drawers, and frames. This step also applies if your cabinetry has been previously painted.

Start with Cabinet Frames:

- A. Thoroughly inspect your cabinet frames for heavy grease or dirt. Pay special attention to areas around the stove, microwave, and sink. Clean these extra greasy or dirty areas with soapy water and wipe clean.
- B. Wearing gloves, fold a scrub pad in half and apply the Deglosser liberally on the scrub pad. Scrub the entire cabinet frame thoroughly to remove dirt and grease. This will degloss the surface, allowing maximum adhesion of the Bond Coat.

IMPORTANT: When deglossing wooden cabinetry, follow the grain pattern of the wood. Avoid scrubbing in a circular motion. Wipe up any spilled Deglosser with a clean cloth.

C. After deglossing, wipe down the frames with a damp cloth to remove any trace of the Deglosser. If you see any soapy suds on the surface, continue to wipe with damp cloth until eliminated. Next, wipe with a dry cloth to complete the cleaning process.

Continue with Cabinet Doors and Drawers:

- D. Inspect cabinet doors and drawers for heavy grease or dirt. Pay special attention to doors and drawers that were near the stove, microwave, or sink as well as areas around handles and knobs. Clean these extra greasy or dirty areas with soapy water, rinse well and wipe clean.
- E. Degloss the fronts, backs, and sides of all doors as well as the fronts and backs of all drawers. Wearing gloves, fold a scrub pad in half and apply the Deglosser liberally on the scrub pad. Scrub each door and drawer thoroughly. Be sure to press firmly on the scrub pad on all parts of the doors and drawers, focusing on greasy or dirty areas.
- F. After deglossing, wipe down each door and drawer with a damp cloth to remove any trace of the Deglosser. If you see any soapy suds on the surface, continue to wipe with a damp cloth until eliminated. Next wipe with a dry cloth to complete the cleaning process.



After applying the Deglosser, allow doors, drawers, and frames to dry 1 hour before applying Bond Coat.

STEP #2 – APPLY BOND COAT

The Bond Coat is specially formulated to provide maximum adhesion to wood, laminate, and melamine surfaces. Two coats of Bond Coat are recommended.

IMPORTANT: You will have enough Bond Coat to cover the outer cabinet frame, each drawer front, and the front and back of each door with two coats. There is NOT enough to coat the insides of the cabinets or shelves.

Start with Cabinet Frames:

- Before applying the Bond Coat, wipe all frames, doors, and drawers with a dry, lint-free cloth to remove any dirt or residue left on the surface.
- Tape the inside edges of each cabinet frame with smooth painter's tape. Be sure all edges are pressed down to ensure that none of the coating will be able to bleed through.
- Thoroughly stir the Bond Coat using a stir stick and pour a portion into a clean, disposable container. Starting with the cabinet frames, use a 2" angled or straight synthetic brush to apply an even coat of Bond Coat.



*Avoid drips, apply in even coats.
Drips may be cleaned up
with water.*

- To ensure best look, use-up-and-down brush strokes on stiles and frame sides. Use side-to-side brush strokes on the rails (see diagram to right). Once the first coat is completely dry (approximately 2 - 3 hrs.), apply a second coat.

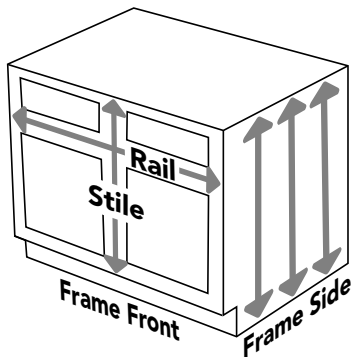

Continue with Cabinet Doors and Drawers:

- E. For easier application purposes, use a prop to elevate the door off the worktable.
See "Cabinetry Preparation & Repair" in the FAQ Section for additional tips.
- F. Begin with the **BACK SIDE** of each door. Use a 2" angled or straight synthetic brush to apply an even coat of Bond Coat.

Use the following application method:

1. Apply Bond Coat to all four inside corners and sides
2. Coat center panel with long, smooth vertical strokes
3. Coat the top and bottom portions with long, horizontal strokes
4. Brush outer sides in a vertical motion

Note: For flat panel doors use up-and-down vertical strokes. Use side-to-side horizontal strokes on drawers.

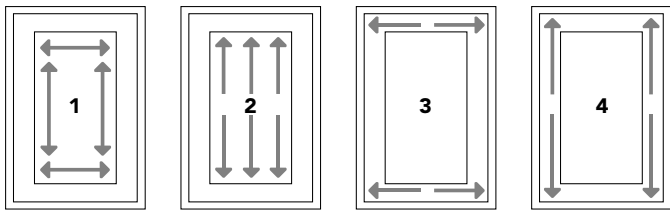

- G. Look for excess Bond Coat in corners and crevasses and use the paint brush to remove build up. Let dry for 2 – 3 hours.
- H. Once the first coat is dry, come back and complete a second coat using the same method. Let dry for an additional 2 – 3 hours.

I. Continue to the **FRONT SIDE** of each door and drawer. When the back side of each door has two coats and is completely dry (approximately 2 – 3 hours), carefully turn the doors over. Apply two coats of Bond Coat to each door and drawer front using the same application process described in steps “F – H” shown on the previous page. Be sure to coat the door and drawer edges when completing the fronts, watching for drips.



Allow Bond Coat to dry 2 – 3 hours between each coat. It is critical to let each coat dry to touch. Dry times may vary depending on temperature and humidity levels.

STEP #3 – DECORATIVE GLAZE (Optional)

The Decorative Glaze enhances the look of your cabinets by accenting the Bond Coat colour giving a high-end, custom look. If you don't wish to complete this step, you may skip ahead to the final Protective Top Coat step. Note: Glaze will appear subtle on dark colours.

- A. Thoroughly mix the Decorative Glaze using a stir stick and pour a portion of the Decorative Glaze into a clean, disposable container. Using a 2” foam brush or 2” synthetic brush, generously brush the entire door panel with Decorative Glaze. Be sure to get Decorative Glaze in all corners, crevices, and raised panel sections.
- B. Next, gather two pieces of Decorative Glazing Cloth and wipe off a majority of the glaze using long, smooth strokes. Wipe the surface using varying pressure, in the direction of the grain or brushmarks to remove the Decorative Glaze to your desired look.
- C. Experiment with the amount of glaze you want to leave behind. Light pressure will leave more glaze on the surface whereas more pressure will take off more glaze.



The Decorative Glaze will stay workable for up to 5 minutes.

For best results, rotate and re-fold the cloth often. For a traditional glazing style, leave more Decorative Glaze in the grooves and corners.

D. Once you have found the desired look, use the first door as a guide for colour, texture and style for the rest of your doors, drawers, and cabinet



For additional and advanced glazing techniques, visit RustoleumTransformations.com.

frames. For a consistent, professional look, have one person complete all of the glazing. Note: Glazing the backs of doors is optional. Let dry a minimum of 8 hours or overnight.



Allow the Decorative Glaze to dry for a minimum of 8 hours before applying the Protective Top Coat.

STEP #4 – APPLY PROTECTIVE TOP COAT

The Protective Top Coat is formulated with self cross-linking technology that provides superior stain and scratch resistance.

A. Wearing gloves and safety glasses thoroughly mix the Protective Top Coat with the stir stick provided. Keep kids and pets out of the room until the finish dries to avoid accidental fingerprints and smudges.

IMPORTANT: The Protective Top Coat dries quickly - do not rebrush previously coated areas that have started to dry.

B. Use a 5cm (2") angled or straight synthetic paintbrush to apply an even layer of Protective Top Coat to the cabinet box and frame. As when you applied the Bond Coat, use up-and-down brush strokes on the cabinet sides and stiles. Use side-to-side brush strokes on the horizontal rails. Once finished, visually inspect the surface and touch up light areas where more Protective Top Coat is needed.

C. Once complete, apply the Protective Top Coat to the **BACK SIDE** of the door first. Apply using the Bond Coat application process in "STEP #2." Only one coat of Protective Top Coat is required. Allow 2 hours to dry.

- D. Next, coat the **FRONT SIDE** of the doors and drawers just as you applied to the door backs. Remember to avoid overbrushing in previously coated areas. If build-up occurs in recessed areas, simply wipe out using a clean, dry synthetic paint brush.
- E. Once the Protective Top Coat is completely dry, carefully inspect the surface and touch up missed areas where more Protective Top Coat is needed.
- F. Allow the Protective Top Coat to dry undisturbed for at least 12 hours. Make sure to keep windows closed, pets away and ceiling fans off.
- G. After 12 hours, you can install your cabinet drawer and door hardware. Keep drawers and doors ajar until completely dry. Install plastic or cork bumpers to backs of doors and drawers. Allow 24 hours before resuming full use.
- H. The Protective Top Coat will cure completely within 7-10 days. Dry times will vary depending on your weather conditions. Avoid using cleaners on new cabinetry for 7 days.



Allow to dry 12 hours before installing cabinet doors and drawers.



Allow 24 hours before full use.

• TRUSTED QUALITY SINCE 1921 •

RUST-OLEUM®

Cabinet Transformations™

FAQs & Cabinet Care Tips

For additional information visit:
rustoleum.ca

GENERAL TRANSFORMATIONS QUESTIONS

Q. IS CABINET TRANSFORMATIONS™ SAFE TO USE?

A. Cabinet Transformations™ is safe to use and is low odor. All products in the system are water based and can be cleaned up with soap and water. Use care and follow supplied instructions for wearing gloves and safety glasses as indicated.

Q. DOES CABINET TRANSFORMATIONS WORK ON LAMINATE OR MELAMINE CABINETRY?

A. Yes, Cabinet Transformations™ works on all wood, laminate, and melamine surfaces providing the same beautiful look.

Q. CAN I USE CABINET TRANSFORMATIONS™ ON SURFACES OTHER THAN KITCHEN CABINETRY?

A. Yes, Cabinet Transformations™ is also great for end tables, dressers, chairs, armoires, and more.

CABINETS PREPARATION & REPAIR

- Q. DO I HAVE TO STRIP, SAND, OR PRIME MY CABINETS AS PART OF THE PREPARATION?**
- A.** Stripping, sanding, or priming are not necessary with Cabinet Transformations™. Simply use the Deglosser and scrub pads provided to prepare your cabinets prior to applying the Bond Coat.
- Q. PRIOR TO USING CABINET TRANSFORMATIONS™, HOW DO I REPAIR CRACKS OR HOLES IN MY ORIGINAL CABINETS?**
- A.** Cracks, holes, nicks, and gouges can be filled with plastic wood filler. When the filler dries, sand the area until it is even with the surrounding surface. Once repairs have been made, follow the normal Cabinet Transformations™ application process.
- Q. CAN I CHANGE OUT MY CABINET HARDWARE?**
- A.** Yes, changing out cabinet knobs, pulls and handles is a great way to update and continue your transformation. Be sure to purchase new hardware prior to starting the Cabinet Transformations™ application process. Check to see if new or different holes are needed. Fill all holes not needed with plastic wood filler. Allow to dry and sand smooth to the surrounding areas. Once holes are filled, follow the normal Cabinet Transformations™ application process.
- Q. DO I NEED TO REMOVE CABINET DOORS AND HARDWARE?**
- A.** For the best results, removing cabinet doors and all cabinet hardware is recommended. It will be easier to get a smooth finish when coating the doors while they are lying flat.
- Q. WHAT CAN I USE TO PROP UP MY CABINET DOORS DURING THE APPLICATION PROCESS?**
- A.** To make the process easier, drive two drywall screws into a 2X4. Set two of these on your worktable to support each door and make the sides of your doors easier to coat. See the Instructional DVD included in the kit for further details.

CABINETRY PREPARATION & REPAIR continued

Q. I HAVE OAK CABINETS; WILL THE WOOD GRAIN SHOW THROUGH?

- A.** The solid colour Bond Coat will allow some of the natural beauty of the wood grain to come through especially on open grain species like oak. If you do not desire the wood grain appearance, use a wood grain filler prior to coating. Follow the wood grain filler manufacturer's instructions for application.

Q. I HAVE KNOTTY PINE CABINETS; WILL THESE REQUIRE ANY SPECIAL PREPARATION?

- A.** The knots, like those in knotty pine, can be an issue when coating. The resin in the knots can bleed through and ruin a finished surface. Simply prime the entire surface with a pigmented shellac base primer such as Zinsser® B-I-N® Primer and proceed with your project.

Q. IF I AM PAINTING OVER RAW WOOD, WHAT ADDITIONAL STEPS MUST I TAKE TO ENSURE PROPER ABSORPTION OF THE BOND COAT?

- A.** If painting over raw wood, it is recommended to use a primer such as Zinsser® Bulls Eye® 1-2-3 Primer to properly seal the surface. You may need to lightly sand away any raised wood grain.

APPLICATION TIPS

Q. SHOULD I PAINT THE INSIDE OF MY CABINET FRAMES OR DRAWERS?

- A.** It is recommended that all cabinet frames, doors and drawers be coated with two even coats. There is not, however, enough Bond Coat to cover the inside of the cabinet frames or drawers. To ensure a clean, even look, tape the insides edges of each cabinet frame with smooth painter's tape. Be sure all edges are pressed down to ensure that none of the coating will be able to bleed through.

APPLICATION TIPS continued

Q. HOW DO I REFINISH AROUND STOVES, DISHWASHERS, AND OTHER APPLIANCES?

- A.** Mask stoves, dishwashers, and other appliances with smooth painter's tape. Be diligent about pressing in the edge to ensure none of the coating will bleed through. Place drop cloths over countertop surfaces and floors.

Q. HOW CAN I AVOID POTENTIAL APPEARANCE PROBLEMS?

- A.** Apply the Bond Coat and Protective Top Coat in even coats brushing with the grain of the wood. Be sure to avoid drips. If drips occur, brush over while wet or clean up with water when dry. Use a premium-quality paint brush throughout the application process for a smooth finish.

Q. WHERE CAN I LEARN MORE ABOUT ADDITIONAL GLAZING TECHNIQUES?

- A.** The traditional glazing technique is used in the Instructional Pamphlet directions. For additional glazing techniques visit RustoleumTransformations.com

Q. I'VE APPLIED THE DECORATIVE GLAZE, BUT DO NOT LIKE THE WAY IT LOOKS- WHAT CAN I DO?

- A.** The Decorative Glaze stays wet 3-5 minutes. While wet, simply use Decorative Glazing Cloth to remove glaze from surface. If the Decorative Glaze has dried, use a clean, damp cloth to remove glaze from surface. Note: If applying over open grain cabinetry, such as Oak, you may not be able to remove all Decorative Glaze from the surface. If this is the case, you will need to apply another coat of Bond Coat followed by the Protective Top Coat.

Q. DO I HAVE TO USE THE DECORATIVE GLAZE?

- A.** Using the Decorative Glaze is optional and does not add additional performance benefits to the system. If you do not wish to use the Decorative Glaze, simply skip "STEP #3" in the application process.

APPLICATION TIPS *continued*

Q. CAN I SPRAY OR ROLL ON CABINET TRANSFORMATIONS™?

A. It is not recommended to spray or roll on the Bond Coat of the Cabinet Transformations™ if you plan on applying the Decorative Glaze. As the glaze is wiped off with the Decorative Glazing Cloth, some glaze naturally remains in the vertical grooves made by the brush marks from the Bond Coat. Spraying or rolling on the Bond Coat eliminates the possibility of achieving this effect.

Q. CAN I SPRAY CABINET TRANSFORMATIONS IF I DO NOT INTEND TO USE THE DECORATIVE GLAZE?

A. You may spray Cabinet Transformations™ only when you do not intend to use Decorative Glaze in the system. To spray the Bond Coat, reduce with up to 30% water and use a HVLP sprayer at 35psi. To spray the Protective Top Coat, reduce with up to 10% water and use a HVLP sprayer at 35psi. Ideal spray temperature and humidity conditions are 25 °C (78 °F) with 35% humidity.

Q. HOW DO HUMIDITY AND TEMPERATURE AFFECT THE COATING APPLICATION PROCESS?

A. Higher humidity will cause the coating to dry more slowly while lower humidity will cause the coating to dry more quickly. Apply when air (ambient) temperature is 50-90°F (10-32°C) and relative humidity is below 60%.

Q. HOW DO I DISPOSE OF UNUSED PRODUCT AND SOILED RAGS OR BRUSHES?

A. Cover any unused products tightly for storage. All tools can be cleaned with water. Discard unwanted product according to local regulations.

APPLICATION TIPS continued

- Q.** HOW LONG SHOULD I WAIT BEFORE INSTALLING MY CABINET DOORS, DRAWERS, AND HARDWARE AFTER USING CABINET TRANSFORMATIONS™?
- A.** Cabinet doors, drawers, and hardware can be installed as early as 12 hours after the final coat of Protective Top Coat has been applied. Keep drawers and doors ajar until the Protective Top Coat is completely dry. Install plastic or cork bumpers. The Protective Top Coat will cure completely after 7-10 days. Dry times will vary depending on your weather conditions. Avoid using cleaners on new cabinetry for 7 days.

MAINTENANCE AND CARE

- Q.** HOW DO I SAFELY MAINTAIN MY NEW CABINET TRANSFORMATIONS™ SURFACE?
- A.** Caring for your resurfaced cabinets is easy. To clean the surface, use a damp cloth or sponge and a mild soap or detergent.
- Q.** HOW LONG WILL CABINET TRANSFORMATIONS™ LAST?
- A.** With normal use and proper care, your refinished surface will last for years.

SAFETY INFORMATION

AVOID CONTACT WITH SKIN, EYES AND CLOTHING. WEAR EYE PROTECTION, GLOVES AND PROTECTIVE CLOTHING. WASH THOROUGHLY AFTER HANDLING.

For skin contact, wash affected area with soap and water and rinse well.

FIRST AID: In case of contact with eyes, flush with cold water for 15 minutes.

If swallowed, do not induce vomiting. Drink 1-2 glasses of water or milk.

Contact a physician immediately.

KEEP OUT OF REACH OF CHILDREN. DO NOT TAKE INTERNALLY.

Additional Information and Technical Help

For More Information visit: rustoleum.ca or call 1-800-387-3625.

CAUTION: *Use only in a well ventilated area. Do not breathe vapours. Avoid contact with eyes and skin. KEEP OUT OF REACH OF CHILDREN.*



An **RPM** Company

©2011 Rust-Oleum Corporation

1-800-387-3625

rustoleum.ca